

*We Strongly Believe
in Service to
Our Clients through
Our Products*



GATE VALVE



GLOBE VALVE



BALL VALVE



CHECK VALVE

Ammonia Service – Sanco Valves :

Sanco valves are engineered for performance and reliability in the most hazardous industrial processes such as severe ammonia applications.

Valve Types :

- GATE VALVE
- BALL VALVE
- GLOBE VALVE
- BUTTERFLY VALVE

Size : 2” to 24”

Pressure Class : 150 To 900 Class

Ammonia Uses & Operating Conditions:

Ammonia is a colorless gas that consists of nitrogen and hydrogen (NH₃). At atmospheric conditions, it is lighter than air with a pungent odor. It is a highly caustic irritant that is both toxic and flammable. Because of its low boiling point, as a liquid it must be stored under pressure or at a low temperature. Industrial ammonia is sold either as ammonia liquor or as pressurized or refrigerated anhydrous liquid ammonia transported in tank cars or cylinders. Household ammonia or ammonium hydroxide is a solution of NH₃ in water. Most ammonia is consumed in the manufacturing of fertilizer. It is also a building block for the synthesis of many pharmaceutical products and is used in many commercial cleaning products.

Typical Operating Conditions:

- Low to high temperature: -50 – 1200° F (-45 – 660° C)
- High pressure: 100 – 3200 psig
- Complex flow scheme / massive recirculation
- High-pressure steam

Select Sanco Materials for Ammonia:

Due to the toxic nature of ammonia, all valve components must be constructed with appropriate materials. Carbon steel & Stainless Steel is suitable for anhydrous ammonia applications, however if moisture is present, stainless steel should be the choice material.

GATE VALVE

CLASS 150 - 300 - 600
Api 600 - BS1414

Length ANSI B16.10 - Flange ANSI B16.5

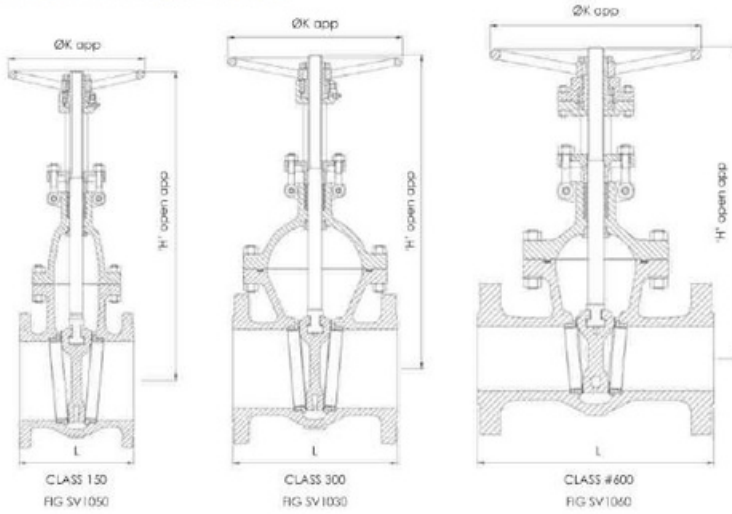

DIMENSION TABLE #150

SIZE	in	2	2.5	3	4	5	6	8	10	12	14	16	18	20	22	24
	mm	50	65	80	100	125	150	200	250	300	350	400	450	500	550	600
L		7.0 178	7.5 190	8.0 203	9.0 229	10.0 254	10.5 267	11.5 292	13.0 330	14.0 354	15.0 381	16.0 406	17.0 432	18.0 457	19.0 483	20.0 508
L1		8.5 216	9.5 241	11.12 282.5	12.0 305	15.0 381	15.9 403	16.5 449	18.0 457	19.8 502	22.5 572	24.0 610	26.0 660	28 711	30.0 762	32.0 813
H app		400	445	485	600	725	765	985	1220	1395	1500	1775	2000	2210	2530	2725
ØK app		200	200	250	250	300	300	350	450	500	559	559	610	610	660	660
Wt. kg app		20	28	33	55	70	90	130	225	330	450	530	625	825	1150	1210

DIMENSION TABLE #300

SIZE	in	2	2.5	3	4	5	6	8	10	12	14	16	18	20	22	24
	mm	50	65	80	100	125	150	200	250	300	350	400	450	500	550	600
L		8.5 216	9.5 241	11.12 282.5	12.0 305	15.0 381	15.88 403	16.5 419	18.0 457	19.8 502	30.0 762	33.0 838	36.0 914	39.0 991	43.0 1092	45.0 1143
L1		8.5 216	9.5 241	11.12 282.5	12.0 305	15.0 381	15.88 403	16.5 419	18.0 457	19.8 502	30.0 762	33.0 838	36.0 914	39.0 991	43.0 1092	45.0 1143
H app		410	450	485	615	725	835	1015	1230	1555	1720	1970	2160	2410	2550	2810
ØK app		200	250	250	300	350	350	450	500	500	600	600	680	760	760	760
Wt. kg app		32	35	55	80	100	150	225	350	480	745	1060	1325	1725	1900	2570

DIMENSION TABLE #600

SIZE	in	2	2.5	3	4	5	6	8	10	12	14	16	18	20	22	24
	mm	50	65	80	100	125	150	200	250	300	350	400	450	500	550	600
L		11.5 292	13.0 330	14.0 356	17.0 432	20.0 508	22.0 559	26.0 660	31.0 787	33.0 838	35.0 889	39.0 991	43.0 1092	47.0 1194	51.0 1292	55.0 1397
L1		11.5 209	13.0 330	12.0 356	17.0 432	20.0 508	22.0 559	26.0 660	31.0 787	33.0 838	35.0 889	39.0 991	43.0 1092	47.0 1194	51.0 1295	55.0 1397
H app		410	485	560	705	800	895	1125	1400	1535	1825	1955	2140	2310	2680	2680
ØK app		250	250	350	450	500	500	600	680	760	760	760	760	813	889	500
Wt. kg app		32	56	72	136	170	245	432	780	835	1190	1690	2010	2400	2650	3700

PARTS MATERIAL SPECIFICATION

PARTS	MATERIAL SPECIFICATION		
BODY	WCB	WC6	CF8/CF8M
BONNET	WCB	WC6	CF8/CF8M
YOKE	WCB	WC6	CF8/CF8M
WEDGE	13 CR. FACING ON WCB	13 CR. FACING ON WC6	CF8/CF8M
SEATING RING	13 CR. FACING ON A5 15-70	S.S. 304	T304 / T316 CF8 / CF8M
BACK SEAT	T410	INTEGRAL	
SPINDLE	T410	T304/T316	
GLAND BUSH	T410	T304/T316	
GLAND FLANGE	CARBON STEEL / WCB		S.S. 304
YOKE SLEEVE	ASTM A 439 GR.D2/ AL-BRONZE		
YOKE NUT	ASTM A 515-70		S.S. 304
HAND WHEEL	CARBON STEEL		
HAND WHEEL NUT	CARBON STEEL		
	S.S. 304		
STUD & NUT	B7/2H	B16/7	B7/2H
EYE BOLT & NUT	B7/ 2H		B8/ 8
GROSS BOLT & NUT	B7/ 2H		B8/ 8
GASKET	CORR. SOFT IRON	CORR. S.S. 304	CORR. S.S. 304/316
GLAND PACKING	GRAPHITE ASB. INHIB. & INCONEL WIRE REIN. /GRAPHOIL		
GRUB SCREW	STEEL		
GREASE NIPPLE	BRASS / STEEL		
NAME PLATE	ALUMINIUM/SS		

BALL VALVE

CLASS 150 - 300 - 800
BS5351

Length 150/300 ANSI B16.10 - Flange ANSI B16.5

DIMENSION TABLE #150 FLOATING BALL VALVE 1-PIECE REDUCE BORE								
SIZE	in mm	1 25	1.5 40	2 50	2.5 6.5	3 80	4 100	6 150
L		5.0 127	6.5 165	7.0 178	7.5 190	8.0 203	9.0 229	10.5 267
H app		9.5	100	125	140	175	195	235
K app		220	220	220	320	320	385	500
ØP		17	28	36	50	57	75	98
Wt. kg app		3	6	8.5	17	21	30	42

DIMENSION TABLE #300 FLOATING BALL VALVE 1-PIECE REDUCE BORE								
SIZE	in mm	1 25	1.5 40	2 50	2.5 6.5	3 80	4 100	6 150
L		5.0 127	6.5 165	7.0 178	7.5 190	8.0 203	9.0 229	10.5 267
H app		9.5	100	125	140	175	195	235
K app		220	220	220	320	320	385	500
ØP		17	28	36	50	57	75	98
Wt. kg app		3	6	8.5	17	21	30	42

DIMENSION TABLE #800 BALL VALVE WITH NIPPLE							
SIZE	in mm	0.5 15	0.75 20	1 25	1.25 32	1.5 40	2 50
L		10.8 275	11.0 280	11.8 300	12.4 315	12.6 320	13.8 350
H app		70	80	90	105	110	125
K app		130	140	160	240	240	240
ØP		12	19	24	30	37	50
Wt. kg app		1.4	2	3.5	6	7	8

DIMENSION TABLE #800 SOCKET / SCREWED END							
SIZE	in mm	0.5 15	0.75 20	1 25	1.25 32	1.5 40	2 50
L		3.1 80	3.3 85	3.9 100	4.5 115	5.1 130	5.9 150
H app		70	80	90	105	110	125
K app		130	140	160	240	240	240
ØP		12	19	24	30	37	50
Wt. kg app		1.4	2	3.5	6	7	8

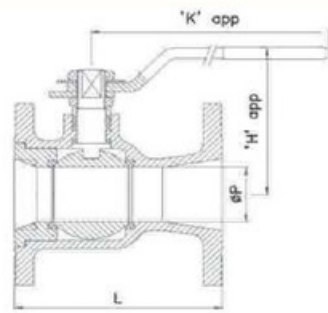

CLASS 150
FIG SV50151R

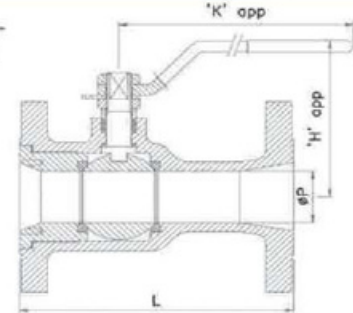

CLASS 300
FIG SV50301R

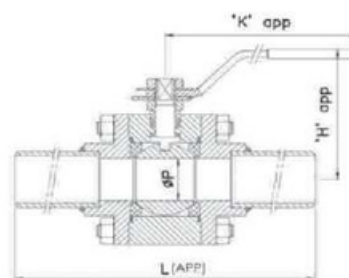

CLASS 800 WITH NIPPLE
FIG 5080E

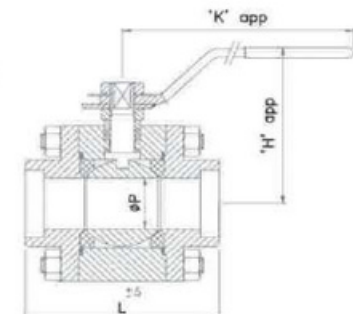

CLASS 800
FIG 5080SW



PARTS	MATERIAL SPECIFICATION		
BODY	WCB/A105	CF8	CF8M
BALL	T304/CF8/CF8M		T316/CF8M
SEAT	PTFE		
SPINDLE	T410/T304/316	T304	T316
GLAND BUSH	T410/T304/316	T304	T316
HANDLE	STEEL WITH PVC CAP		
HANDLE NUT	STEEL	T304	
STUD & NUT		B7/ 2H	
GASKET	PTFE		
GLAND PACKING	PTFE		
BOTTOM WASHER	PTFE		
END PIECE	WCB	CF8	CF8M
GLAND NUT	CARBON STEEL	T304	T316
NAME PLATE	ALUMINIUM/SS		
POSITION INDICATOR	ALUMINIUM/SS		

BALL VALVE

CLASS 150 - 300
BS5351

Length ANSI B16.10 - Flange ANSI B16.5

DIMENSION TABLE #150 FLOATING BALL VALVE 2-3 PIECE FULL BORE										
SIZE	in	1.5	2	2.5	3	4	6	8	10	12
	mm	40	50	65	80	100	150	200	250	300
L		6.5 165	7.0 178	7.5 191	8.0 203	9.0 229	15.5 394	18.0 457	21.0 533	24.0 610
H app		100	125	140	150	180	270	325	390	540
K app		220	220	320	320	385	500	600	450	450
ØP		37	49	64	75	98	148	198	248	298
Wt. kg app		9	14	20	27	40	90	165	225	325



DIMENSION TABLE #300 FLOATING BALL VALVE 2-3 PIECE FULL BORE								
SIZE	in	1.5	2	2.5	3	4	6	8
	mm	40	50	65	80	100	150	200
L		7.5 190	8.5 216	9.5 241	11.1 282	12.0 305	15.9 403	19.75 502
H app		120	135	150	170	190	300	360
K app		220	220	320	320	385	500	450
ØP		37	49	64	75	98	148	198
Wt. kg app		12	18	28	35	55	110	235

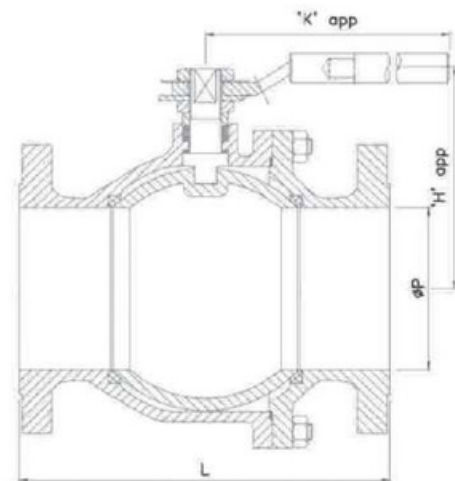

CLASS 150/300 2PIECE
FIG SV50152F

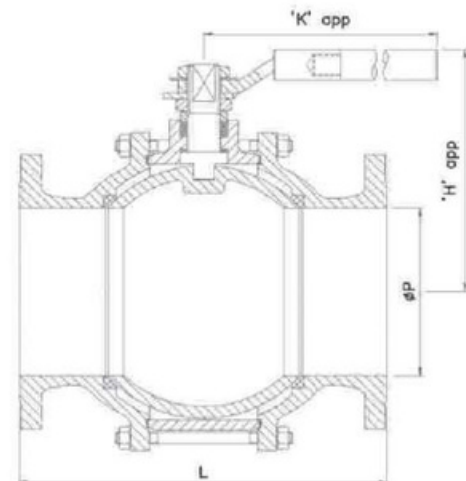

CLASS 150/300 3PIECE
FIG SV50153F

PARTS	MARERIAL SPECIFICATION		
BODY	WCB	CF8	CF8M
BALL	T304/CF8/CF8M		T316/CF8M
SEAT	PTFE		PTFE
SPINDLE	T410/T304/316	T304	T316
GLAND BUSH	T410/T304/316	T304	T316
HANDLE	STEEL		
HANDLE NUT	STEEL	T304	
STUD & NUT	B7/ 2H		
GASKET	PTFE		
GLAND PACKING	PTFE		
BOTTOM WASHER	PTFE		
END PIECE	WCB	CF8	CF8M
GLAND NUT	CARBON STEEL	T304	T316
NAME PLATE	ALUMINIUM/SS		
POSITION INDICATOR	ALUMINIUM/SS		



 **ADDRESS:**

VIII/63 G, APPAX ESTATE COMPLEX
OPP. PUDUSSERY PANCHAYATH, KANJIKODE PO
PALAKKAD, KERALA, INDIA, 678623

FOLLOW US



Order on WhatsApp

+91 8593078990



Call us now

+91 95622 79990



Email us at

support@toolsdirect.in

